



- Industrial Operating Temp: -40°C to +85°C
- Storage Temp: -40°C to +85°C

Electrical Specifications @ 25°C

Voltage Rating (VAC)	Current Rating (Amp)	Contact Resistance (mΩ)	Insulation Resistance @ 500VDC (MΩ)	Dielectric Strength 60Hz / 60 Sec
125	1.5 Max	50 Max	500 Min	1000VAC

All specifications subject to change without notice.

MECHANICAL

Dimensions: $\frac{\text{inch}}{\text{mm}}$

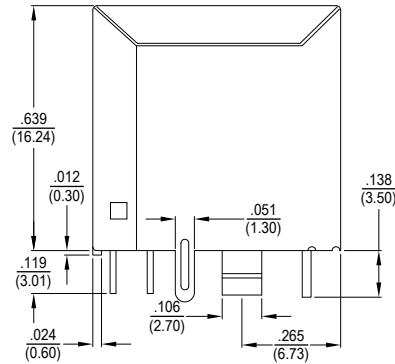
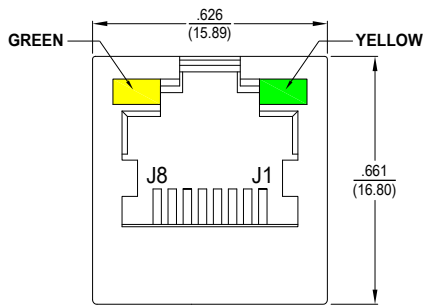

Tolerance ±.008 (0.20mm)

PCB LAYOUT

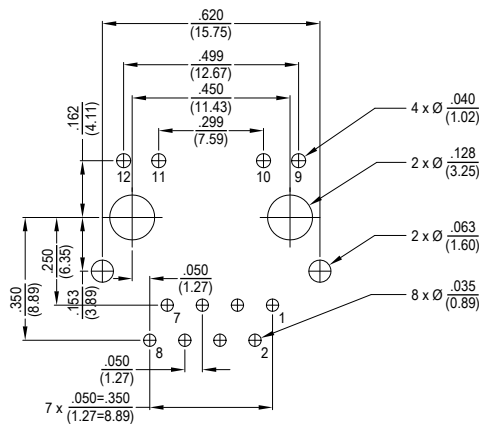

Tolerance ±.008 (0.20mm)

LEDs

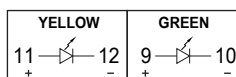

Emitting Color	λp(nm)	VF@IF=20mA	IR@VR=5V
Green	565	1.8-2.6V	10μA Max
Yellow	585	1.8-2.6V	10μA Max

NOTES

Connector Materials:
Housing & Insert: PBT UL94V-0
Contact Material: Phosphor Bronze T= .35mm
Contact Plating: 0.20-0.25mm Thickness brass with Tin Plating