



Single Port RJ45 Connector

AR11-4521



- 10/100 Base T for LAN, WAN and other Ethernet applications
- Meets IEEE 802.3 specification
- Standard Operating Temp: 0°C +70°C

Electrical Specifications @ 25°C

OCL(μH Min) @100KHz, 0.1V	Turns Ratio (±2%)		Return Loss (dB Min)			
With 8mA DC Bias	TX=1CT:1CT	RX=1CT:1CT	1-10MHz	10-30MHz	30-60MHz	60-100MHz
350	1:1	1:1	-20	-16	-12	-10

Electrical Specifications @ 25°C

Cross Talk (dB Min)			Insertion Loss (dB Max)	CMR (dB Typ)		Hi-Pot
1-30MHz	30-60MHz	60-100MHz	1-65MHz	1-50MHz	50-150MHz	
-40	-35	-30	-1.0	-30	-20	1500Vrms

All specifications subject to change without notice.

MECHANICAL

Dimensions: $\frac{\text{inch}}{\text{mm}}$

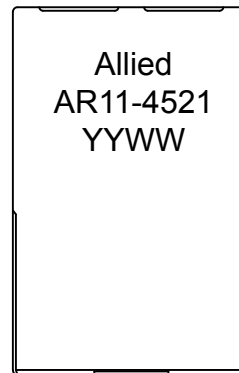
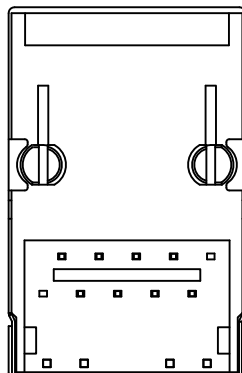
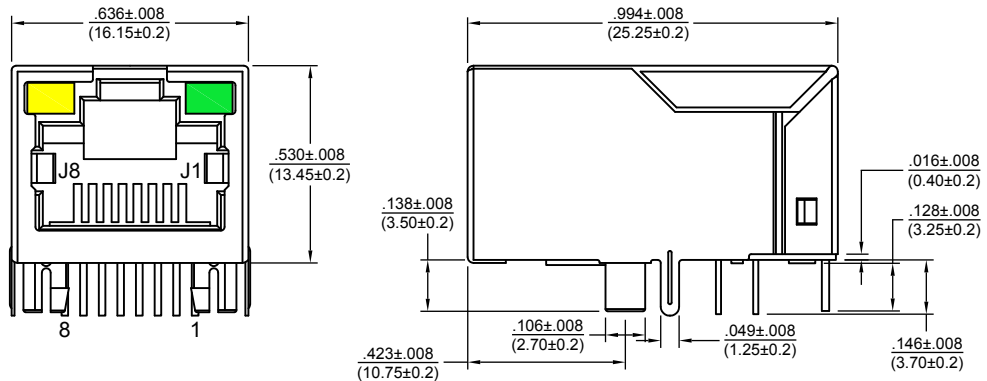



SCHEMATIC

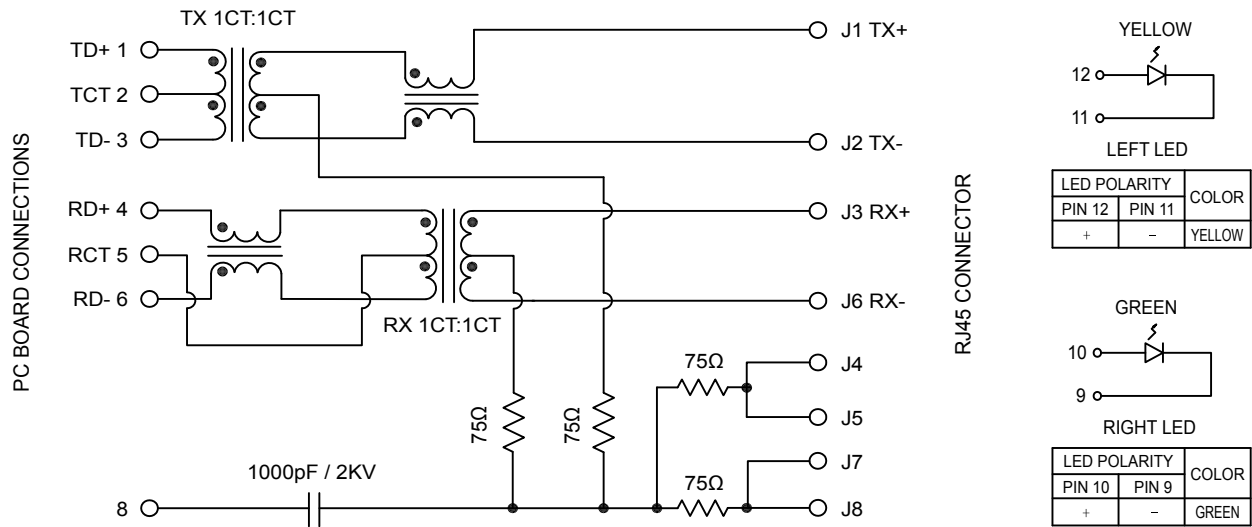

PCB LAYOUT

Dimensions: mm

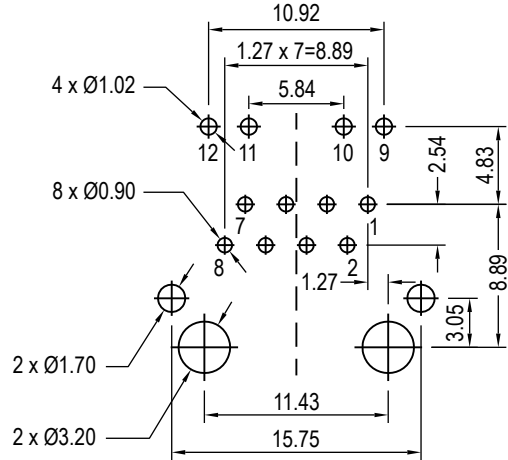

Tolerance is ±0.2mm unless otherwise specified

NOTES

- Connector Materials:
 Housing: Thermoplastic PBT+30% G.F. UL94V-0
 Contact: Phosphor Bronze C5210R-EH Thickness = 0.35mm
 Pins: Brass C2680R-H Thickness = 0.35mm
 Shield: SUS 201-1/2H Thickness = 0.20mm
 Contact Plating: Gold 6µ" min. in contact area
- Insertion Cycles: The minimum number is 750 times, the maximum number is more than 5000 times
- Wave solder tip temperature: 265°C max, 5 sec. max