

FWPQ2617S Flat Wire SMD Power Inductor

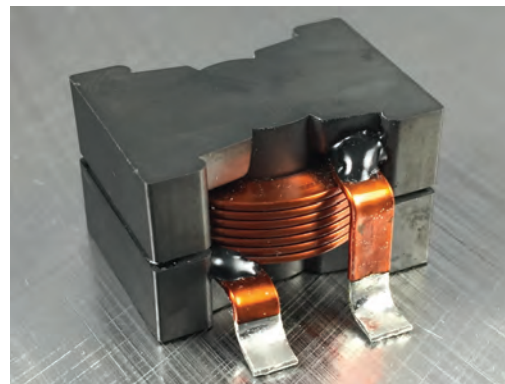
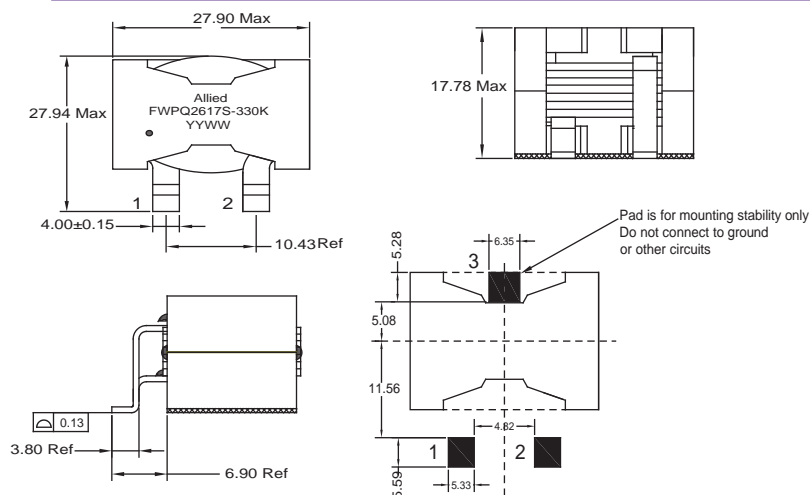

Features

- Flat Wire SMD Power Choke
- Third Solder pad for mounting stability only.
- Low DCR
- High Saturation Current
- Frequency Range up to 1MHz

Allied Part Number	INDUCTANCE ±10% (μ H)	Isat (A)			DCR (m Ω) Max.	I _{rms} (A) Max.
		10% DROP	20% DROP	30% DROP		
FWPQ2617S-330K	33	7.0	8.7	9.6	2.86	28.0

All specifications subject to change without notice.

Electrical

Inductance Range: 33 μ H

Tolerance: 10%

Test Frequency: 100KHz, 100mVrms, 0ADC

Operating Temp: -40°C ~ +85 °C

I_{rms}: Current at which the temperature rise will not exceed 40 °C above ambient.

Isat: Current at which the inductance will drop by no more than the specified amount from its original Inductance without current.

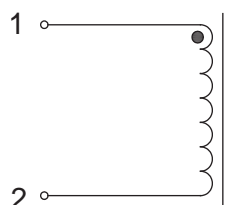

SCHEMATIC

Physical

Packaging: 40 per Tray, 200pcs per Carton

Marking: Part Number / Date Code